

# AHU SOLUTION

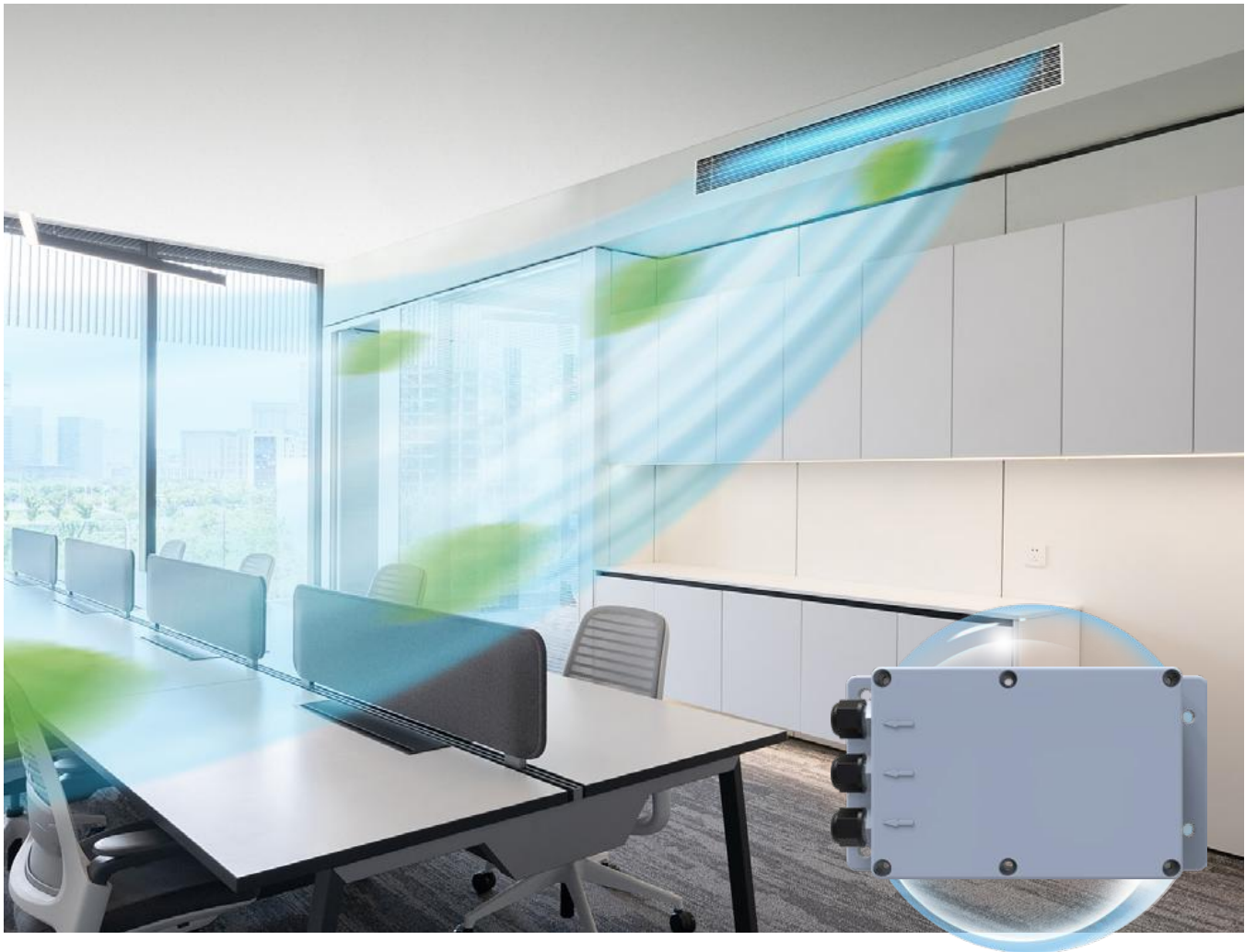

**The Haier Super Match Integration Kit** seamlessly connects third-party AHUs to Haier single split systems (2.5kW-16kW) for complete climate control. Offering cooling/heating mode selection, it adjusts capacity via dip switches and responds to 0-10V AHU signals for precise temperature management. The kit features defrost control, cold-air prevention, error reporting, and IP44-rated waterproof construction for reliable outdoor installation.

## FEATURES AND FUNCTIONS

This Kit can be used to integrate the 3rd party AHU into Haier Super Match single split series. The main features and functions include:

- Capacity range: 2.5KW-16KW. Capacity can be changed by Dip switch
- Receive 0-10V signal from AHU (Field supplied)
- Outdoor unit capacity control based on the 0-10V signal
- To meet the target room temperature through the outdoor capacity control based on the 0-10V signal
- On/off Operation, Cooling/Heating mode selection
- Defrost signal output

## FEATURES AND FUNCTIONS

- Anti-cold air function when outdoor unit conducts defrost
- Error info. output
- IP 44 waterproof certification, which makes outdoor installation possible

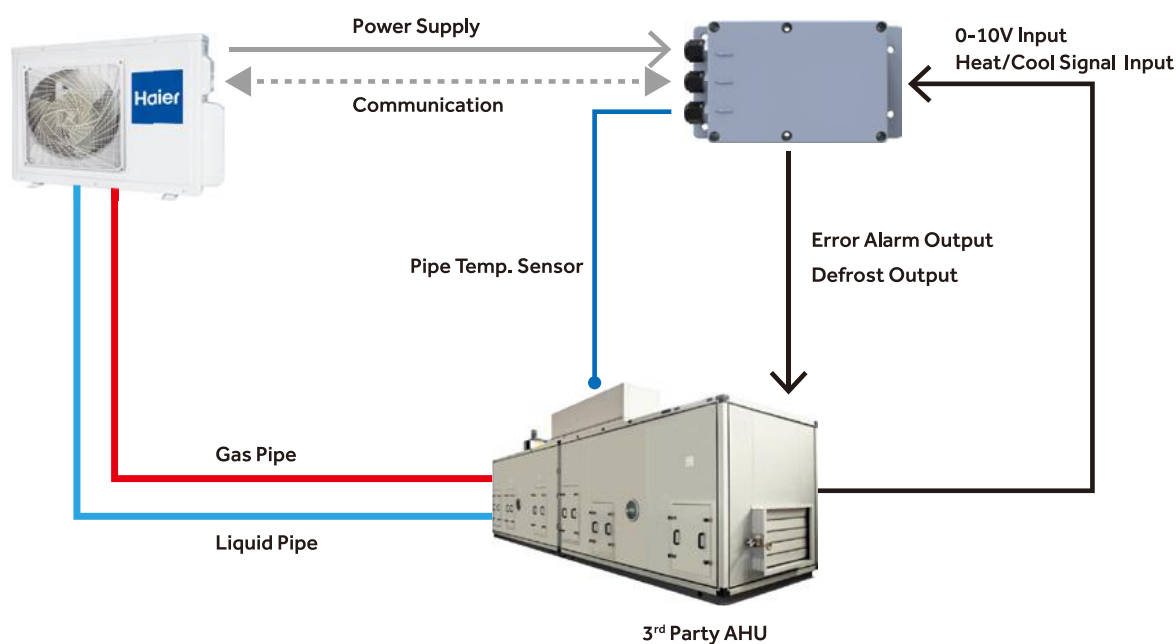

## SPECIFICATION

MODEL	AH1-LCAC1	AH1-RAC1
Power Supply(Ph/V/Hz)	1 Phase/220~240V/50/60Hz	1 Phase/220~240V/50/60Hz
Dimension (W/D/H)mm	206/52.5/110	206/52.5/110
Package Dimension (W/D/H)mm	240/80/120	240/80/120
Colour	Grey	Grey
Weight(KG)	0.4	0.4
Shipping Weight(KG)	0.6	0.6

## COMPATIBILITY

MODEL	Products	AH1-LCAC1	AH1-RAC1
 <p>R32 Match Plus Heat Pump</p>	1U25S2SM1FA-2		●
	1U35S2SM1FA-2		●
	1U42S2SM1FA		●
	1U50S2SJ2FA-2		●
	1U71S2ST1FA	●	
	1U105S2SS1FA	●	
	1U105S2SS2FA	●	
	1U105S2SS1FB	●	
	1U125S2SN2FA	●	
	1U125S2SN2FB	●	
	1U140S2SN1FA	●	
	1U140S2SN1FB	●	
	1U140S2SP2FA	●	
	1U140S2SP2FB	●	
	1U160S2SP1FB	●	